



PRODUCT CATALOG

MAINTENANCE PRODUCT

CATALOG
EDITION

2024-V2-B
01

MAINTENANCE PRODUCTS

FOR RENTAL AND FOR SALE

GREASE

Liquid Valve Flush

PART NO: PLI-200-HP-VF

Our **PL LIQUID VALVE FLUSH** is developed to remove even the most stubborn of hydrocarbon deposits and old hydrocarbon sealants from the seal and spring areas of a valve, without damaging elastomers or seals. It will also dissolve waxes produced in oil production, thus allowing the valves to be effectively flushed prior to lubrication and sealing. It is applied with an air operated liquid injection pump.

All products are being upgraded to reflect use of new synthetic oil immiscible in condensate and white gasoline, improved lubricity and elastomeric bridging properties.

PLI LIQUID VALVE FLUSH is a unique combination of valve penetrant and moisture displacer engineered for today's growing valve maintenance market.

PLI LIQUID VALVE FLUSH is a superior corrosion inhibitor because it safely removes old hydrocarbon deposits and also removes oxidation deposits.

PLI LIQUID VALVE FLUSH will also remove even the toughest sealant deposits that may have solidified in the seal pockets.

In addition to these benefits, it provides an excellent corrosion inhibiting film. This film contains no dangerous chlorinated solvents and provides unsurpassed protection in harsh conditions.

Recommended users of **PLI LIQUID VALVE FLUSH** include valve manufacturers, valve refurbishes, pipeline operators, geothermal power generation plants and geothermal well operators.

BENEFITS

- Corrosion, scale inhibitor and oxidation preventative
- Noncorrosive
- Harmless to valve elastomers
- Dissolves hydrocarbon deposits
- Loosens rust and scale
- Will clean up most metal surfaces
- Max temp range of 500°F

APPLICATION

PLI LIQUID VALVE FLUSH can be applied using an air operated liquid injection pump, or a hand held liquid injection pump.

RECOMMENDED USES

Flushing of seized valves prior to lubrication / sealing, so as to clear out the lubrication passageways, cleaning down of valves.

PACKAGING

20 litres

PART NUMBER

PLI-200-HP-VF



GREASE

Grease Form Valve Cleaner

PART NO: PLI-200-HP-GFVC40

This product is a combination valve cleaner and penetrating lubricant engineered to free up and clean out difficult or impossible to operate lubricated valves.

Pressure Lube Valve Cleaner penetrates and cleans residual gum, lacquer, hardened sealants and lubricants. Valve Cleaner also penetrates and loosens rust and corrosion deposits extending the life and performance of all types of lubricated valves. When used regularly it will prevent additional build up.

FEATURES

- Compatible with all valve lubricants
- Cuts residual gum and lacquer deposits
- Removes rust and corrosion
- Do not use in oxygen service
- Temperature Range -40 to 400°F
- Ideal for valves orientated at an angle

APPLICATION PROCEDURE

Apply the Valve Cleaner with a PLI bucket pump. Turn valve slowly and repeat the process until valve opens freely. After the valve is operable, lubricate with one of PLI's high quality valve lubricants, or sealant.

PART NUMBER

PLI-200-HP-GFVC 40

Manufactured in the USA by Lubchem for PLI formulation.



GREASE

Valve Lubricant

PART NO: PLI-200-HP-LUBE

We developed our SYNTHETIC VALVE LUBRICANT to be used in continual P.M. systems as a cheaper alternative to costly sealants. PLI's synthetic lubricant is resilient to all products coming up a production string or produced in a gas processing plant. This reduces the need to stock various types of lubricants and therefore reduces costs. Since it is fully synthetic it will also not harden or block up the injection ports reducing torque and giving a perfect seal even after repeated cycling. This lubricant can be used in ball, gate and plug valves. For geothermal valves, you may use the specially formulated SYNTHETIC GEOTHERMAL LUBRICANT, a high temperature (up to 900F) lubricant, developed for geothermal use. Our updated 2010 products will also now resist condensate.

PLI HIGH PERFORMANCE SYNTHETIC VALVE LUBRICANT is an excellent valve lubricant which reduces friction during operation of valves. PLI HIGH PERFORMANCE SYNTHETIC VALVE LUBRICANT allows valves to turn easily, thereby extending their lifetime and performance.

PLI HIGH PERFORMANCE SYNTHETIC VALVE LUBRICANT is resistant to solvents and chemicals including hydrogen sulphide, crude oil, diesel, carbon dioxide, hydrochloric acid, brine, water and condensates, as well as drilling muds. PLI HIGH PERFORMANCE SYNTHETIC VALVE LUBRICANT is waterproof, will not harden, and adheres to metal assuring protection against rust and corrosion.

BENEFITS

- Non-melting and non-hardening
- Rust, corrosion and oxidation preventative
- Resists hydrogen sulphide, crude oil, oilfield brine water, diesel and sea water
- Insoluble in water
- Serves temperatures up to 600°F
- Will not wash out

APPLICATION

PLI HIGH PERFORMANCE SYNTHETIC VALVE LUBRICANT can be applied using an air operated lubrication pump, or a hand held great gun or a volume bucket pump.

RECOMMENDED USES

By valve manufacturers, valve refurbishes, pipeline and wellhead companies, refineries, chemical processing plants and LNG plants.

PACKAGING

40Lb Pails (20 Ltr)

PART NUMBER

PLI-200-HP-LUBE



GREASE

Valve Sealant

PART NO: PLI-200-HP-SEAL

PLI's SYNTHETIC VALVE SEALANT is a last line of defence in valve maintenance, i.e. a valve must be sealed at all costs to eliminate the need for an untimely shut down. Our valve sealant contains no PTFE-fillers, will not harden and is excellent for emergency seat renewal and low pressure sealing problems. It comes in various grades, but the standard grade is good for H²S and CO² services. The 2010 product will be immiscible in condensate.

By using a unique combination of 100% fully synthetic oils and a propriety thickener, PLI HIGH PERFORMANCE VALVE SEALANT was formulated to provide a superior lubricating and sealing compound that is unsurpassed in performance.

There are no fillers such as clay, bentonite or soaps or PTFE PLI HIGH PERFORMANCE VALVE SEALANT does not rely on these fillers as bridging agents.

When injected into the valve, PLI HIGH PERFORMANCE VALVE SEALANT lubricates and seals with as much as 90 percent greater efficiency. PLI HIGH PERFORMANCE VALVE SEALANT will not harden in valve seats or lubrication channels thus eliminating frequent flushing of the valve and allowing for torque operation.

PLI HIGH PERFORMANCE VALVE SEALANT will resist wash outs by crude condensate, water, gas, diesel, hydrocarbon acid, oil field brine, H²S, CO² and is insoluble in water. It can withstand a wide temperature range from -60F to 500F.

BENEFITS

- 100% Synthetic
- Does not contain fillers
- Low friction coefficient
- Resistant to water washout
- Protects from corrosion
- Effective temperature range of -60°F to 500°F
- Protects against H²S and CO²

APPLICATION

PLI HIGH PERFORMANCE VALVE SEALANT can be applied using an air operated lubrication pump, a hand held grease gun or a volume bucket pump.

RECOMMENDED USES

By Valve manufacturers, valve refurbishes, pipeline and wellhead companies, refineries and LNG plants.

PACKAGING

40Lb Pails (20 Ltr)

PART NUMBER

PLI-200-HP-SEAL



GREASE

Super Blue Valve Sealant

PART NO: PLI-200-HP-SB-SEAL

SYNTHETIC SUPER BLUE VALVE SEALANT is a last line of defence in valve maintenance, i.e. a valve must be sealed at all costs to eliminate the need for an untimely shut down. Our Super Blue Valve Sealant will not harden and is excellent for emergency sealing when nothing else works.

Note: This product is extremely viscous. The Super Blue Hydraulic injection pump is required to inject Super Blue valve sealant into valves.

PACKAGING

40Lb Pails (20 Ltr)

PART NUMBER

PLI-200-HP-SB-SEAL



Super Condensate Sealant (Grey)

PART NO: PLI-200-HP-SC-SEAL

PLI SUPER CONDENSATE VALVE SEALANT (GREY) is a last line of defence in valve maintenance, i.e. a valve must be sealed at all costs to eliminate the need for an untimely shut down.

Our valve sealant contains no PTFE fillers, will not harden and is excellent for emergency seat renewal and low pressure sealing problems. It is designed for H²S and CO² service and is immiscible in condensate. This elevates the problem of valves becoming seized or stiff to cycle in condensate service, and improves valves integrity to seal online.

PACKAGING

40Lb Pails (20 Ltr)

PART NUMBER

PLI-200-HP-SC-SEAL



GREASE

Anti Seize 2200

PART NO: PLI-200-AS-2200

The PLI ANTI SEIZE 2200 is a synthetic oil based graphite aluminium powder. An anti-seize paste for bushing, bearings, gears and chains. The application resists chemicals, gases (except oxygen) and solvents where two metals meet.

PACKAGING

1Lb Can (454g)

PART NUMBER

PLI-200-AS-2200



Stick Packing 686

PART NO: PLI-200-SP-686

STICK PACKING 686 is a clean odourless, pliable packing used to seal stuffing boxes. 686 is a petroleum hydrocarbon free stick packing made with LIQUILON®. 686 continues to seal and lubricate long after conventional packing has failed. Regardless of the size of the stuffing box, 686 will form itself to the configuration of the box and shaft and compensates for wear by remoulding itself. 686 can be used as a supplement to worn conventional packing or intervals with conventional packing. 686 services temperatures to 400°F (204°C) and pressures up to 10,000 psi. 686 Packing is unaffected by most acids, oils, caustics, and common solvents.

TYPICAL OBSERVATIONS

Colour: Green

Odour: None

Form: Self Forming Sticks

Shape: Square

Size: ½" x ½" x 2½" Equilateral

Active Component: LIQUILON®

Specific Gravity: 1.4

Water-Repellent: Yes

Water-Resistant: Yes

Service Temperature: 400°F (204°C)

Solubility in Water: Insoluble

PACKAGING

1Lb Jar (454g)

PART NUMBER

PLI-200-SP-686

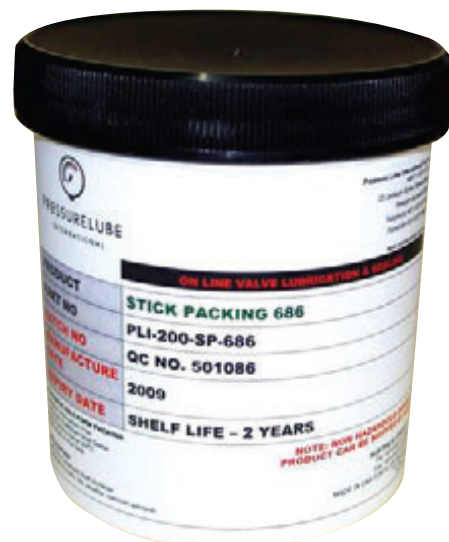

GREASE

Stick Packing 636G

PART NO: PLI-200-SP-636G

STICK PACKING 636G is a clean, odourless, pliable packing used to seal stuffing boxes. Made with LIQUILON®*, 636G continues to seal and lubricate long after conventional packing has failed. Regardless of the size of the stuffing box, 636G forms itself to the configuration of the box and shaft and compensates for wear by remoulding itself. 636G can be used as a supplement to worn conventional packing or intervals with conventional packing. 636G serves temperatures to >400°F (>204°C) and pressures to 10,000 psi. 636G is unaffected by acids, oils, caustics, or common solvents.

TYPICAL OBSERVATIONS

Form Moldable sticks

Shape Triangular prisms

Size ½" x ½" x ½" x 2½"

Equilateral

Color Green

Odor None

Active Component LIQUILON®

Water-Repellant Yes

Water-Resistant Yes

Service Temperature Up to >400°F (>204°C)

Service Pressure Up to 10,000 psi

Solubility in Water Insoluble

Hardness (Durometer) 50 – 60

PACKAGING

1Lb Jar (454g)

PART NUMBER

PLI-200-SP-636G



FITTINGS

Easiflow Vented Cap

PART NO: PLI-EFLF-VC

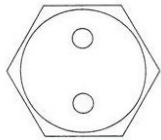

END VIEW OF VENT CAP

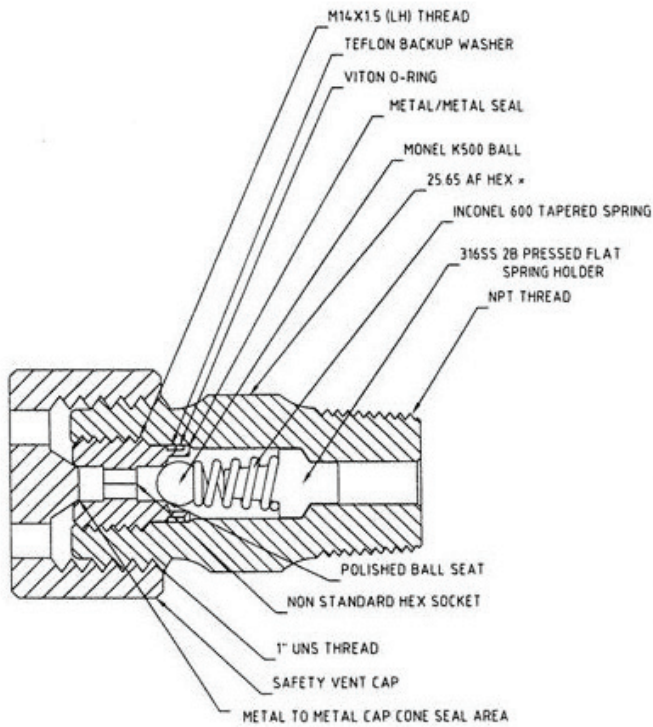

ASSEMBLY DRAWING

EASY FLOW LUBRICATION FITTING

PART#	THREAD SIZE	HEX AF*
PLI-EFLF18	1/8" NPT	25.65
PLI-EFLF14	1/4" NPT	25.65
PLI-EFLF38	3/8" NPT	25.65
PLI-EFLF12	1/2" NPT	25.65
PLI-EFLF34	3/4" NPT	33.05
PLI-EFLF1	1" NPT	39.00

OPTIONS:

- Other threads available on request, including UNC Parallel Threads
- Ball material options include Tungsten Carbide (WC)
- Spring material options include INCONEL X-750
- O-Ring material options available

FITTINGS

Easiflow Long Stem

PART NO: PLI-EFLF-LS

**EASIFLOW LUBRICATION
FITTING LONG STEM**

PLI-EFLF-LS14

PLI-EFLF-LS38

PLI-EFLF-LS12

PLI-EFLF-LS14-NPTT

PLI-EFLF-LS38-NPTT

PLI-EFLF-LS12-NPTT

PLI-EFLF-LS78 NPT

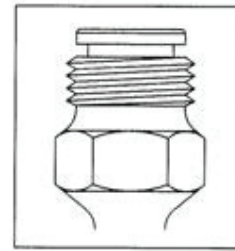

Combination Fitting Available on Request
Suits Both 1" UNS and Giant Button Head Attachment

***n.b.** (The giant head button reduces pressure rating of the fitting)

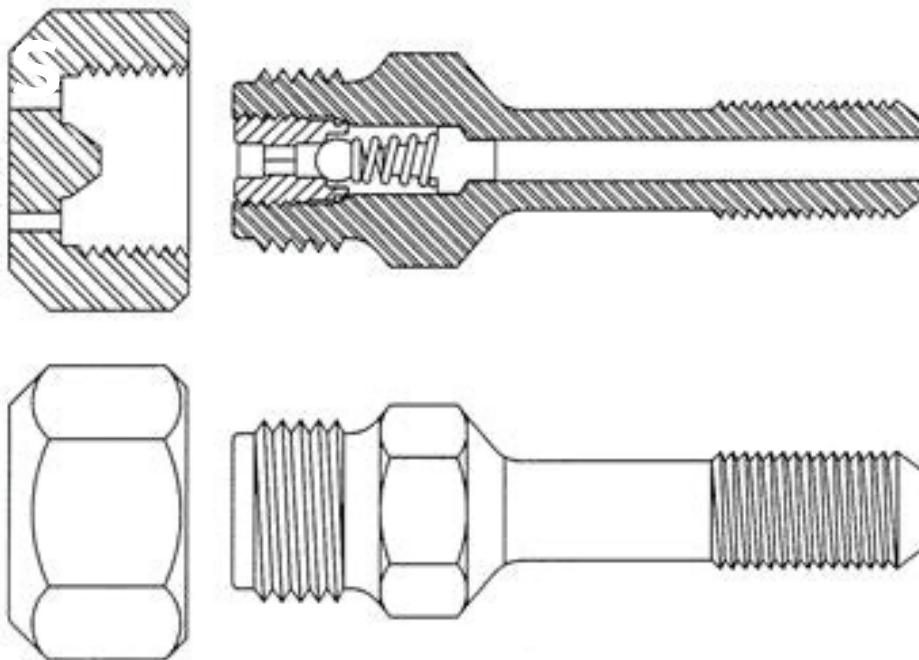

Long Stems Coupled With Parallel Threads are Available to Suit Any Requirement.

FITTINGS

Easy Flow 60 Degrees

PART NO: PLI-EFLF-60D

This image of the Easy Flow Lube Fitting shows the parallel thread and 60 degree sealing shoulder.

PART NUMBER

PLI-EFLF-60D



Easiflow Vented Cap Giant Button Head

PART NO: PLI-EFLF-LS

The Easiflow Vented Cap Giant Button Head suits both UNS and giant button head* attachment – a combination Long Stem fitting is also available.

All manufacturing process, materials used and the internal components of the PLI-EFLF-GBH are the same as PLI-EFLF fitting, The only difference is the addition of the GBH groove.

n.b. (The giant button head groove reduces the pressure rating of the fitting)

PART NUMBER

PLI-EFLF-GBH1
 PLI-EFLF-GBH12
 PLI-EFLF-GBH14
 PLI-EFLF-GBH18
 PLI-EFLF-GBH34
 PLI-EFLF-GBH38



FITTINGS

Cavity Plug

PART NO: PLI-CP

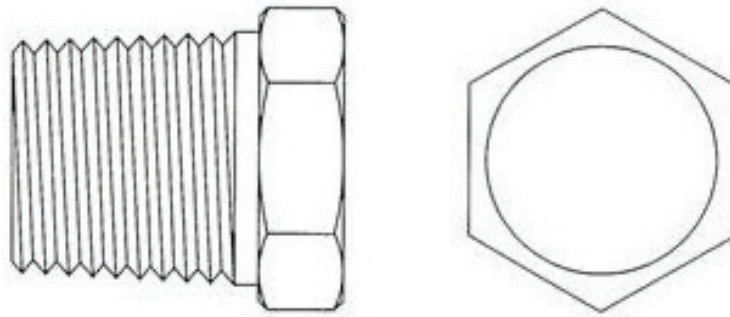

CAVITY PLUG

PART#	THREAD SIZE	HEX AF*
PLI-CP1	1" NPT	316 SS
PLI-CP34	3/4" NPT	316 SS
PLI-CP12	1/2" NPT	316 SS
PLI-CP38	3/8" NPT	316 SS
PLI-CP14	1/4" NPT	316 SS
PLI-CP18	1/8" NPT	316 SS
PLI-CP12-SAF	1/2" SAF	UNS 31803 (Duplex)
PLI-CP14-SAF	1/4" SAF	UNS 31803 (Duplex)
PLI-CP1-SAF	1" SAF	UNS 31803 (Duplex)
PLI-CP34-SAF	3/4" SAF	UNS 31803 (Duplex)
PLI-CP38-SAF	3/8" SAF	UNS 31803 (Duplex)

OPTIONS: Alternate configurations, Threads, Materials and Plating are available on request.

FITTINGS

Packing Glands

PART NO: PLI-PG

Manufactured to order; different configurations, materials & plating available on request.

PART NUMBER

PLI-PG

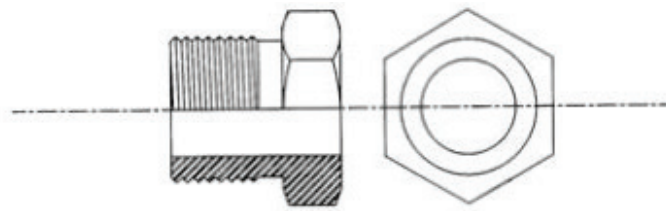

PACKING GLAND	
PART #	PF-PG
<i>OPTIONS</i> : Manufactured To Order Different Configurations, Materials and Plating are Available on Request	

Junk Ring

PART NO: PLI-JR

The Junk Ring is manufactured to order with different configurations, materials and plating available on request.

PART NUMBER

PLI-JR

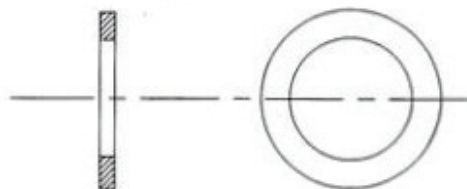

JUNK RINGS	
PART #	PF-JR
<i>OPTIONS</i> : Manufactured To Order Different Configurations, Materials and Plating are Available on Request	

FITTINGS

Body Bleed Fitting

PART NO: PLI-BB

The B.B.F. is used to drain the body cavity pressure.

PART NUMBER
PLI-BB

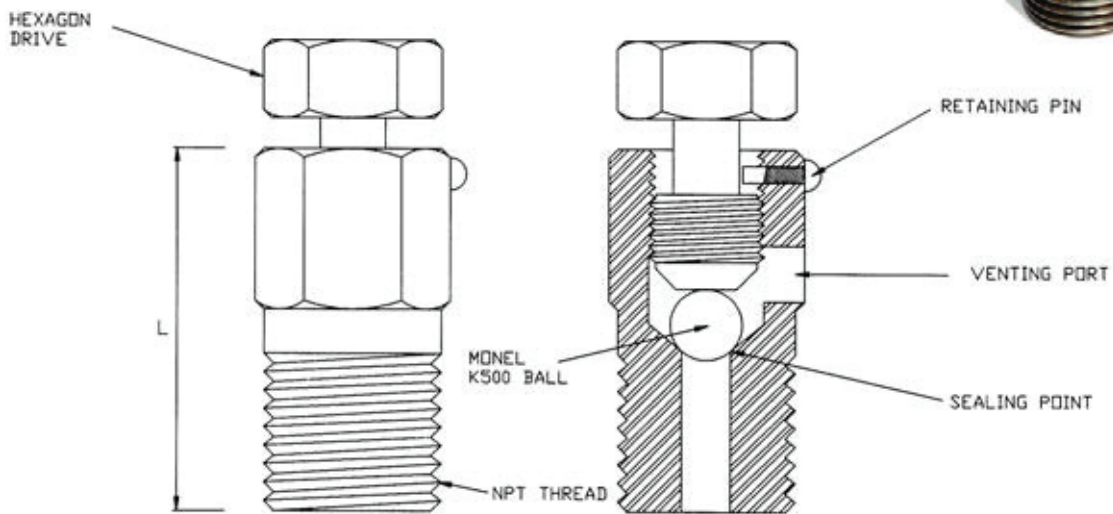

EASY FLOW LUBRICATION FITTING

PART#	THREAD SIZE	MATERIAL	HEX SIZE	L	BALL
PLI-BB112	1 1/2" NPT	316 SS	2"	2 5/8"	Monel K500
PLI-BB114	1 1/4" NPT	316 SS	1 3/4"	2 1/2"	Monel K500
PLI-BB1	1" NPT	316 SS	1 5/16"	2 7/16"	Monel K500
PLI-BB34	3/4" NPT	316 SS	1 1/8"	1 3/4"	Monel K500
PLI-BB12	1/2" NPT	316 SS	7/8"	1 3/4"	Monel K500
PLI-BB38	3/8" NPT	316 SS	7/8"	1 3/4"	Monel K500
PLI-BB14	1/4" NPT	316 SS	7/8"	1 3/4"	Monel K500

OPTIONS: Alternative configurations, threads, materials (UNS S31803 - Duplex) and plating are available on request.

FITTINGS

Internal Check Fitting

PART NO: PLI-ICF

The I.C.F. is installed before the lube fitting.

PART NUMBER
PLI-ICF

SINGLE (FLOATING) BALL CHECK FITTING	
PART#	THREAD SIZE
PLI-IC1	1" - 8
PLI-IC78	7/8" - 9
PLI-IC34	3/4" - 10
PLI-IC12	1/2" - 13
PLI-IC14	1/4" - 20

OPTIONS: Alternate configurations, Threads, Materials and Plating are available on request.

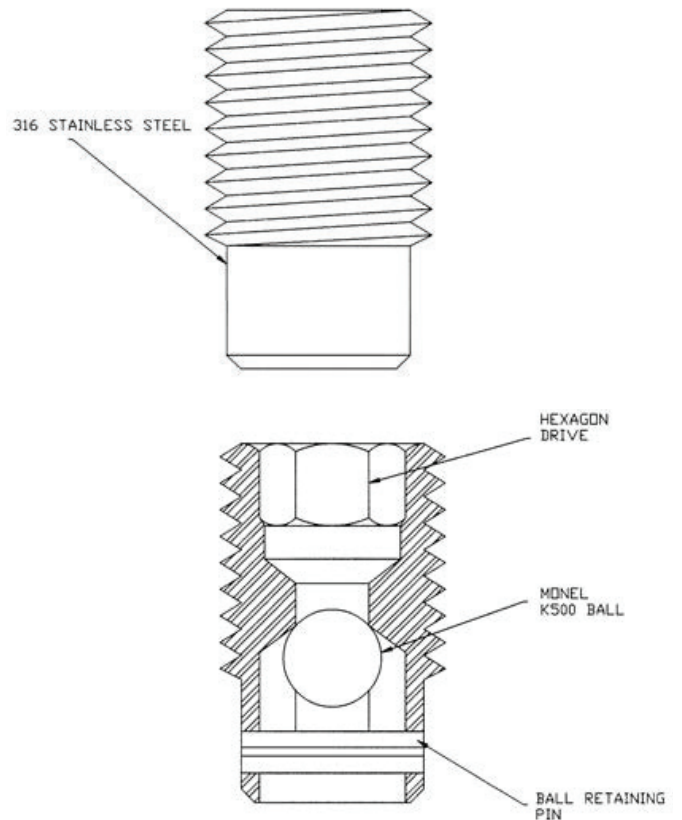

Internal Check Fitting

PART NO: PLI-ICF

The P.I.F. is installed to the stem of a valve to assist in stem sealing.

PART NUMBER
PLI-PIF

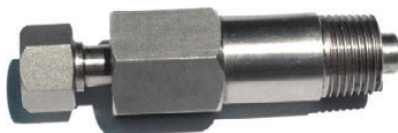

SINGLE (FLOATING) BALL CHECK FITTING	
PART#	THREAD SIZE
MATERIAL	316 SS
PLATING	Zn + Cr ₂ O ₄

OPTIONS: Alternative material (S1214 plated) grades, plating and attachment threads available on request

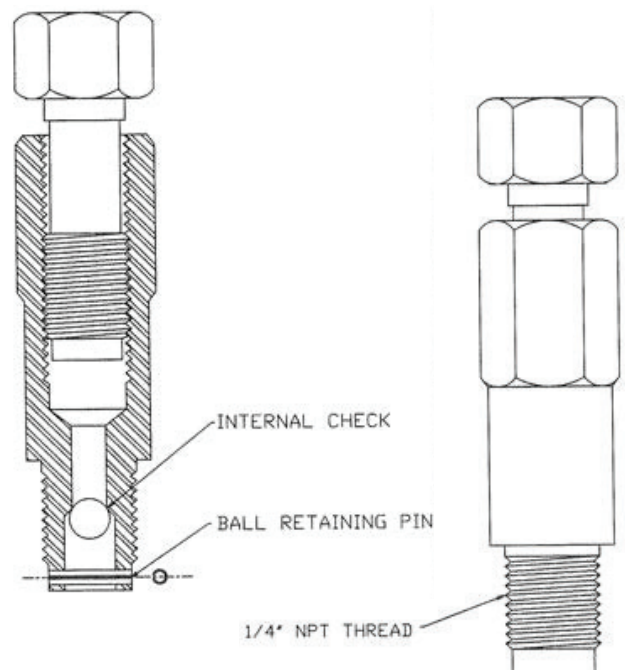

FITTINGS

Pressure Relief Valve

PART NO: PLI-PRV

The PRV is installed into the body of the valve to prevent over pressurising and damage to a valve.

PART NUMBER

PLI-PRV

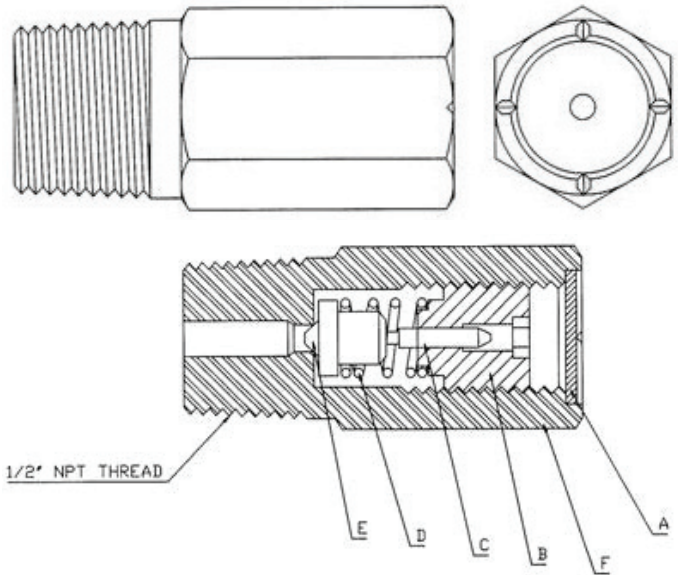

PRESSURE RELIEF VALVE

PART	COMPONENT	MATERIAL
A	Bonnet	ASTM 316
B	Adjusting Screw	ASTM 316
C	Valve Unit	ASTM 316
D	Spring	INCONEL X-750
E	Plug	PEEK
F	Body	ASTM 316

ADAPTORS

Lube Adaptor

PART NO: PLI-LA

The PLI Lube Adaptor is used on the end of a lube whip hose or safety vent coupler for lube fitting connection.

PART NUMBER

PLI-LA

LUBE ADAPTOR	
PART#	TO FIT THREAD
PLI-LA114	1" - 14 UNS
PLI-LA78	7/8" - 14 UNF
PLI-LA34-16	3/4" - 16 UNF

STANDARD MATERIAL: S1214
PLATING: Zn+Cr₂O₄

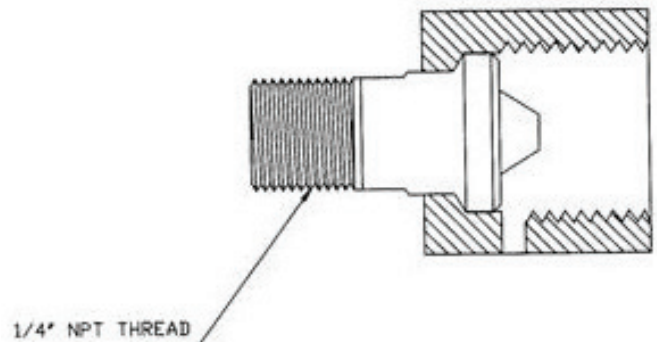
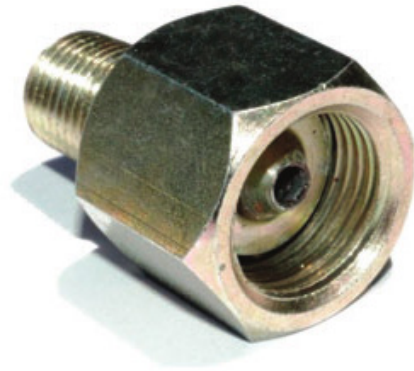

SAFETY TOOLS

Pressure Relief Tool

PART NO: PLI-PRT

The PLI Pressure Relief Tool is used to screw onto the lube fitting to vent pressure.

PART NUMBER

PLI-PRT

PRESSURE RELIEF TOOL	
PART#	TO FIT THREAD
MATERIAL	S1214
PLATING	Zn+Cr ₂ O ₄
STANDARD THREAD	1"-14 UNS

OPTIONS: Alternate Thread Sizes Available on Request

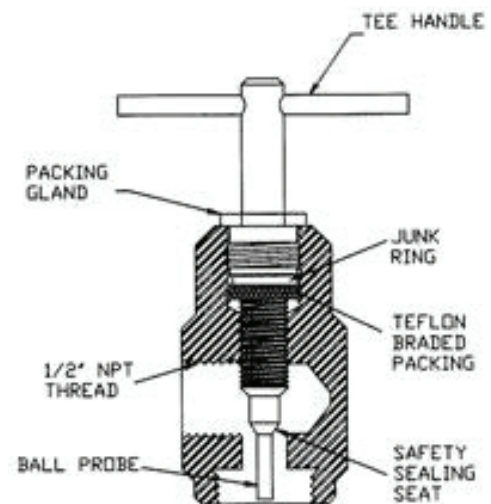
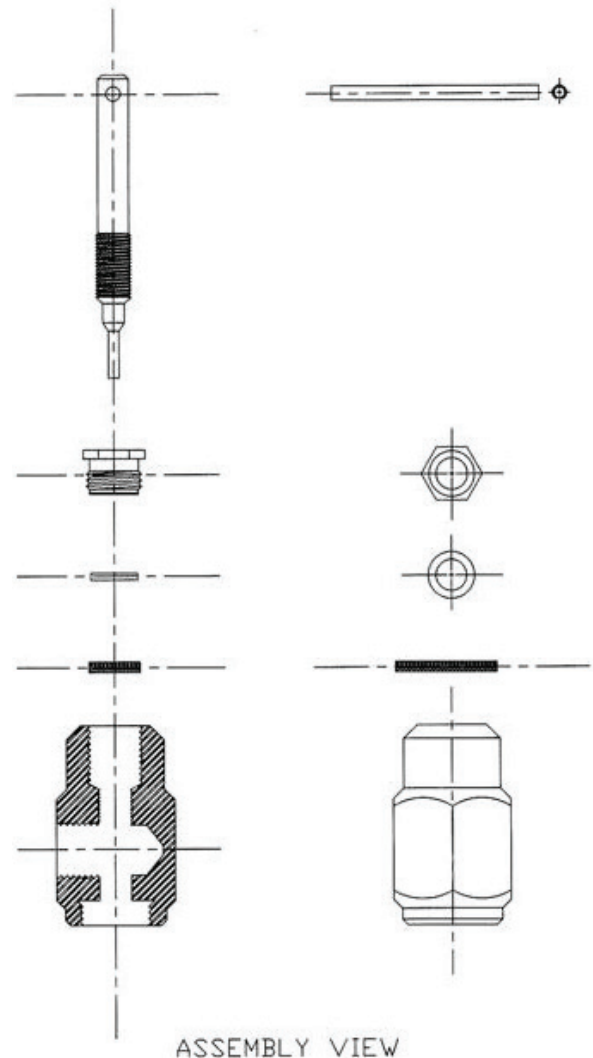

SAFETY TOOLS

Leak Lock Fitting

PART NO: PLI-LLF

The L.L.F. connects to a giant button head fitting. It is used as a lube adapter or to seal a leaking giant button head fitting.

PART NUMBER

PLI-LLF

LEKA LOK FITTING	
PART#	TO SUIT
PLI-LL1	GIANT BUTTON HEAD
PLI-LL2	STANDARD BUTTON HEAD
NUT: MATERIA: S1214 PLATING: Zn+Cr ₂ O ₄	
FITTING: As per standard easy flow fitting	

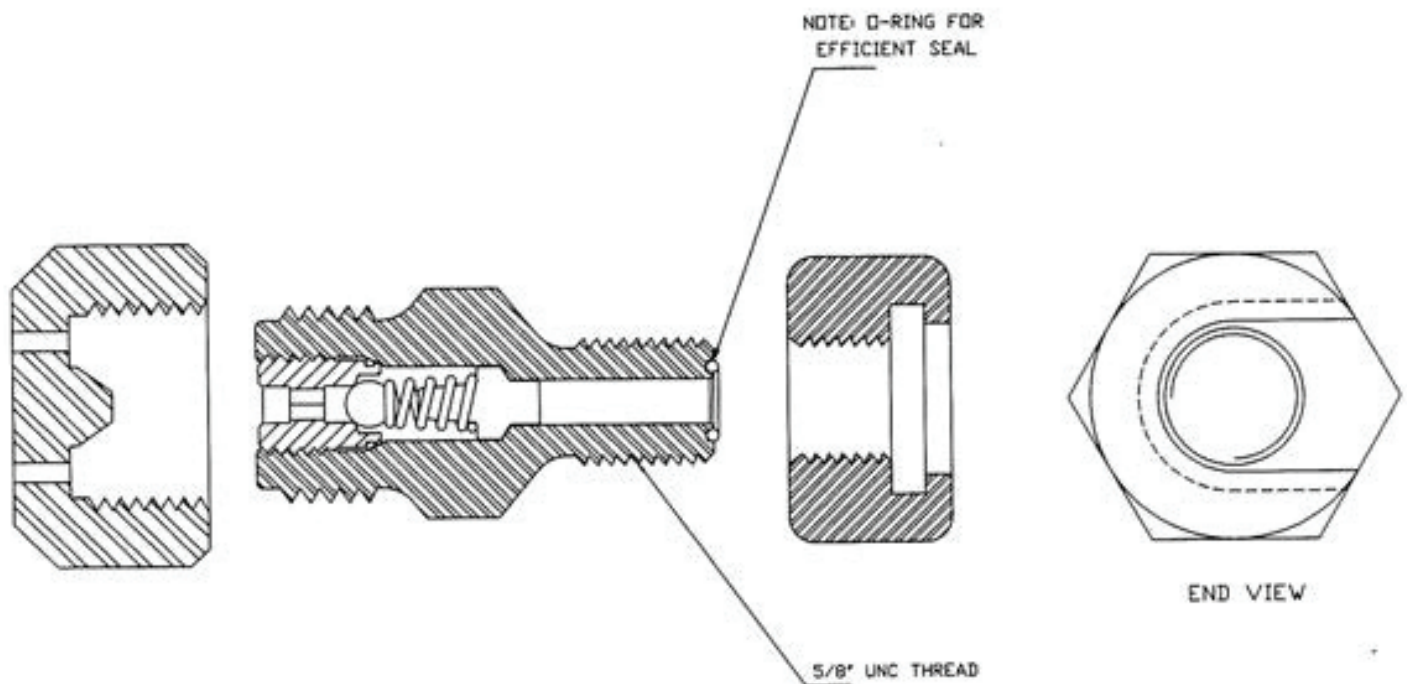

SAFETY TOOLS

Safety Vent Coupler

PART NO: PLI-SVC

The S.V.C. is used on the end of a lube whip hose to vent pressure between S.V.C. and lube fitting. It has a LA114 lube adapter.

PART NUMBER

PLI-SVC

PRESSURE RELIEF TOOL	
PART#	TO FIT THREAD
PART#	PLI-SVC
MATERIAL	S1214
PLATING	Zn+Cr ₂ O ₄



OPTIONS: Other Lube Adaptors and Materials also Available

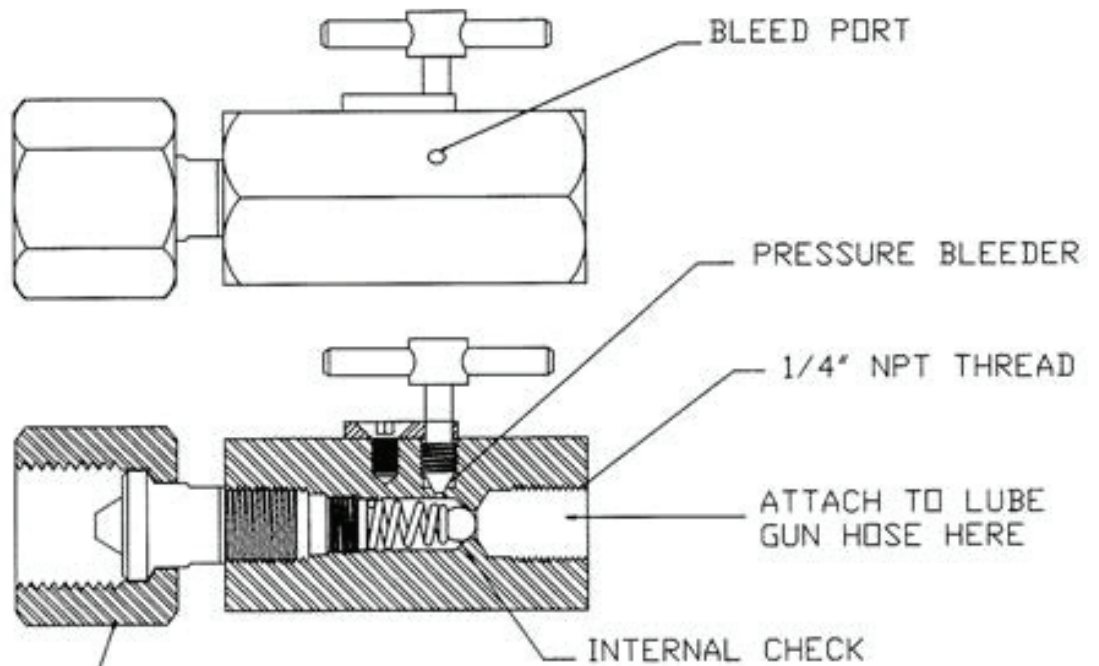

STANDARD PF-LA114
LUBE ADAPTOR

DIESEL AIR COMPRESSOR PUMPS & EQUIPMENT

Flush Pump

PART NO: PLI-FP-SS-TT

The PLI Flush Pump with stainless steel tank and trolley holds 28 litres of Liquid Valve Flush, used for injecting Liquid Valve Flush into the valve for cleaning internal lube ports & components prior to lubing.

PART NUMBER
PLI-FP-SS-TT



SPARE PARTS

1	All Stainless Steel Trolley and Tank
2	Filter Regulator
3	Control Valve for Air Motor On/Off
4	Flush Discharge Hose Connection
5	Pressure Release Valve to Tank
6	10,000 PSI Liquid Pump
7	Pneumatic Tyres
8	Air Motor Filter
9	Filler
10	28 Litre Tank

DIESEL AIR COMPRESSOR PUMPS & EQUIPMENT

Bucket Pump

PART NO: PLI-BP-LW

The PLI Bucket Pump (lightweight) with 7,500 PSI is used for sealant and lubricating pumping.

9649L 7,500 PSI Bucket Pump is designed as a compact light weight, high pressure unit that is easily carried in a helicopter. Good for servicing up to 12" ball valves.

PART NUMBER

PLI-BP-LW



SPARE PARTS

1	Steel Powder Coated Trolley
2	Air Motor
2.1	Spare Part
3	Lube Discharge Hose Connection
4	Pressure Release
5	Pump Tube
5.1	Spare Part
6	Follower Plate
7	Connect Air Hose to Remove Bucket
8	Filter Regulator
9	Air Ram
10	Pneumatic Tyre

DIESEL AIR COMPRESSOR PUMPS & EQUIPMENT

PM3 Pump - Premium

PART NO: PLI-PM3-7PSI PRM

The PLI PM3 Powermaster Pump (Premium) - 7,500 psi high pressure lubricating and sealing pump. The PM3 pump is good for injecting lubricant or sealant in to any size Gate, Plug or Ball Valve.

PART NUMBER

PLI-PM3-7PSI PRM



SPARE PARTS

1.1	Power Valve
1.2	Pilot Bar
1.3	Muffler Filter
1.4	Air Motor Complete
2	Counter with Reset to count air motor strokes from the lube pump
3	High Pressure Safety Tee with needle valve for pump and line pressure release
3.1	Needle Valve - Pressure Release
3.2	Quick Connector
4	Pump Tube
5	Follower Plate O-Ring
5.1	Air Bleed Valve
6	Solid Trolley Frame powder coat painted
7	Safety Guard
8	Air filter / regulator / lubricator (105psi max air pressure)
9	Air Supply In
10	Pneumatic Air Ram
11	Blow off valve to the follower plate for removing the bucket
12	Up/Down air control valve for the air ram on the lube pump
13	On/Off valve for the air motor to the lube pump
14	Identification Tag
15	Pneumatic Tyres

DIESEL AIR COMPRESSOR PUMPS & EQUIPMENT

PM3 Pump

PART NO: PLI-PM3-14PSI

The PLI Powermaster III - 14,000 psi, high pressure lubricating and sealing pump.

This unit is the same frame height as the PM3 7,500 but has a 14,000 PSI lube/sealant pump for the extreme high pressure service work - good for servicing any size valve.

PART NUMBER

PLI-PM3-14PSI

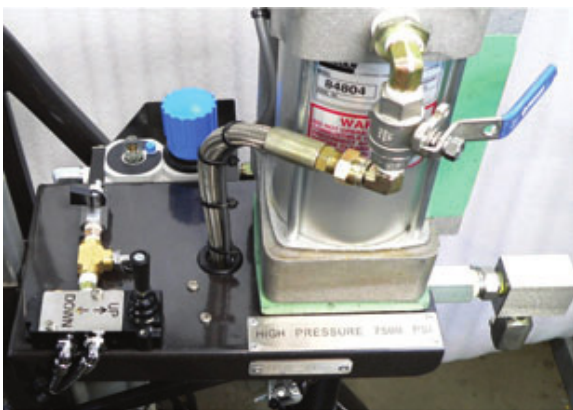

SPARE PARTS

1.1	Power Valve
1.2	Pilot Bar
1.3	Muffler Filter
1.4	Air Motor Complete
2	Counter with Reset to count air motor strokes from the lube pump
3	High Pressure Safety Tee with needle valve for pump and line pressure release
3.1	Needle Valve - Pressure Release
3.2	Quick Connector
4	Pump Tube
5	Follower Plate O-Ring
5.1	Air Bleed Valve
6	Solid Trolley Frame powder coat painted
7	Safety Guard
8	Air filter / regulator / lubricator (105psi max air pressure)
9	Air Supply In
10	Pneumatic Air Ram
11	Blow off valve to the follower plate for removing the bucket
12	Up/Down air control valve for the air ram on the lube pump
13	On/Off valve for the air motor to the lube pump
14	Identification Tag
15	Pneumatic Tyres

DIESEL AIR COMPRESSOR PUMPS & EQUIPMENT

Super Blue Injection Pump

PART NO: PLI-SB-HIP

The PLI Super Blue Sealant is extremely viscous and requires the Super Blue Hydraulic Injection Pump to be able to inject this product into valves. Ordinary grease pumps will not pump the PLI Super Blue Sealant.

PART NUMBER

PLI-SB-HIP

SPARE PARTS

1	Hydraulic Foot Pump
2	Hydraulic Ram
3	Product Compression Chamber
4	Complete Whip
5	Ram Quick Connector

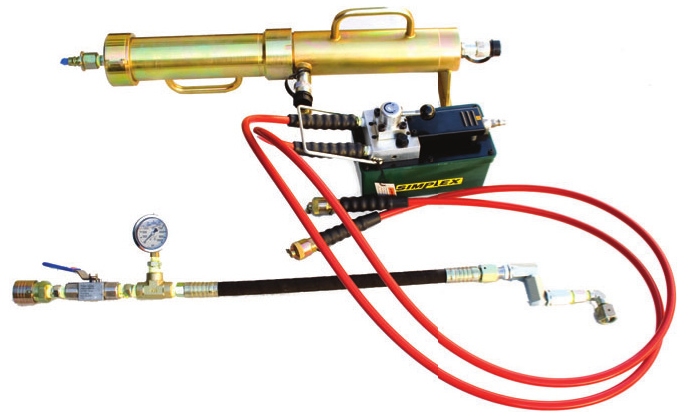

Aluminium Trolley

PART NO: PLI-AT-T

Sturdy Aluminium Trolley, 4 pneumatic wheels for carrying service equipment throughout process plant. Complete with tie-downs, tool tray and air hose reels.

PART NUMBER

PLI-AT-T

SPARE PARTS

1	Aluminium Trolley Powder Coated
2	Pneumatic Tyres
3	Air Supply Hose Reel Complete
4	Lube Supply Hose Reel Complete with Hose
5	Flush Supply Hose Reel Complete with Hose

Note: Pumps are not included.



DIESEL AIR COMPRESSOR PUMPS & EQUIPMENT

Open Skid Unit

PART NO: PLI-OSU

Open Skid Unit with Power Master 3 Lubrication Sealant Pump, 38 litre tank with 10,000 PSI, liquid flush pump, two supply hose reels and full pneumatic control cabinet.

Designed for the back of a 4x4 pickup or a light truck. All equipment is air operated and assembled on a heavy duty steel protective frame.

PART NUMBER

PLI-OSU



SPARE PARTS

1	Complete Air Motor
1.1	Power Valve Seals
1.2	Pilot Bar Seals
1.3	Muffl er Filter
1.4	Air Motor Seals
2	Needle Valve Lube Pressure Release
3	Pneumatic Air Ram
4	Liquid Flush Reel Complete with Hose
5	Lube / Seal Reel Complete with Hose
6	Complete Control Cabinet
7	Follower Plate O-Ring
8	Mini Ball Valve
9	Liquid Flush Pump
10	Flush Tank Level Indicator
11	Pump Tube Complete
11.1	Pump Tube Seals
12	Air Supply Hose for Control Box

DIESEL AIR COMPRESSOR PUMPS & EQUIPMENT

REAR VIEW

SPARE PARTS

4	Liquid Flush Reel Complete with Hose
9	Liquid Flush Pump
12	Air Supply Hose for Control Box

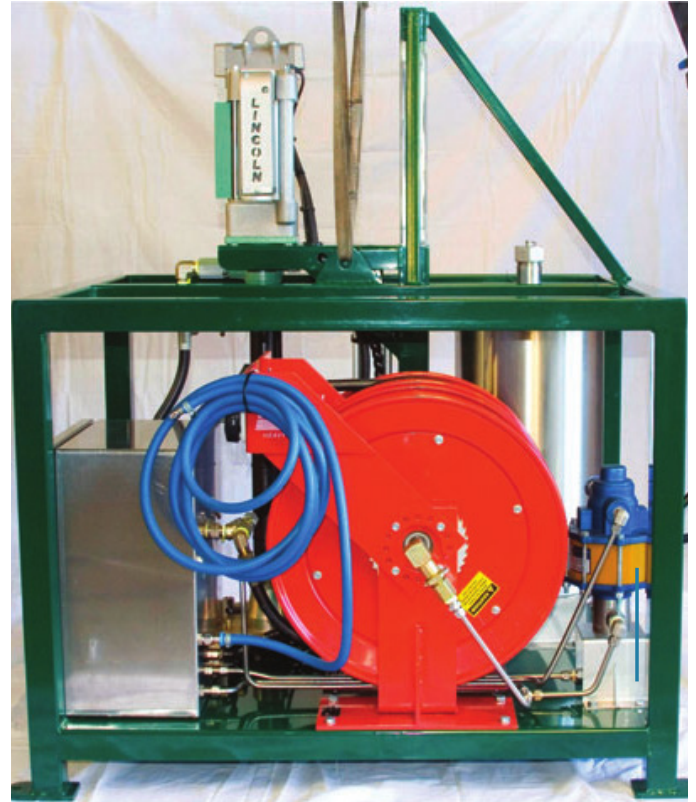

OPEN SKID UNIT CONTROL CABINET

SPARE PARTS

2	Air Filter Regulator
3	Adjustable Oil Lubricator
5	Air Control Valve
6	Pneumatic Counter with Reset
7	Lube Pressure Gauge
8	On/Off Valve for Lube Air Motor
9	Bucket Blowoff Valve
10	On/Off Valve for Flush Pump
11	Flush Pressure Relief Valve
12	Flush Pressure Gauge



DIESEL AIR COMPRESSOR PUMPS & EQUIPMENT

Custom Open Skid Unit

PART NO: PLI-COSU

CUSTOM SIZE

All specifications for this unit are standard as per the "Open Skid Unit" with the added benefit of a custom size frame as per customer request.

PART NUMBER

PLI-COSU

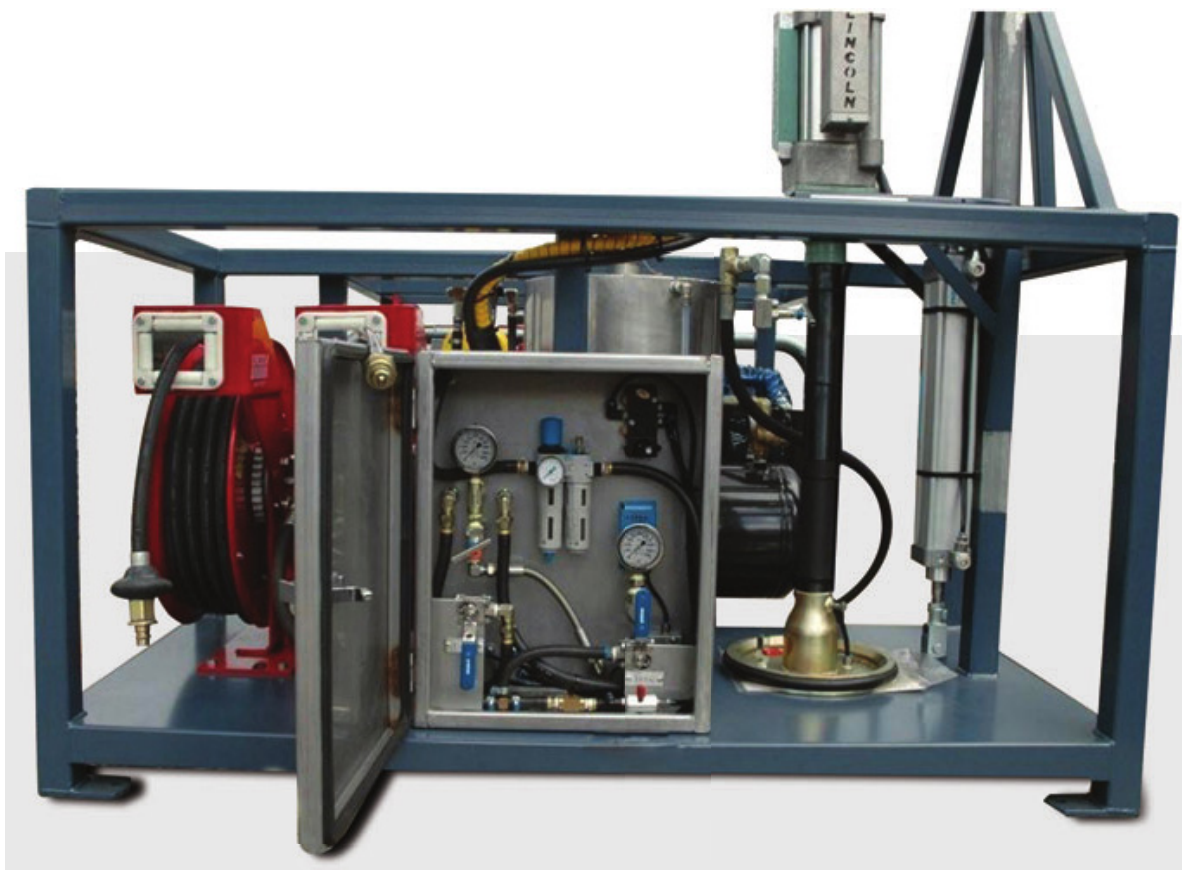

DIESEL AIR COMPRESSOR PUMPS & EQUIPMENT

Diesel Air Compressor (Zone 2)

PART NO: PLI-DPAC-Z2

ZONE 2

Diesel Powered Air Compressor, 30 CFM, 10HP, PULL start, diesel motor, 45 litre receiver, filter regulator with two quick air connectors for air hoses, all electrics are removed.

Emergency and auto shut down controls, spark arrested motor. All assembled on a heavy duty protective steel frame designed to work in the desert.

PART NUMBER

PLI-SB-HIP

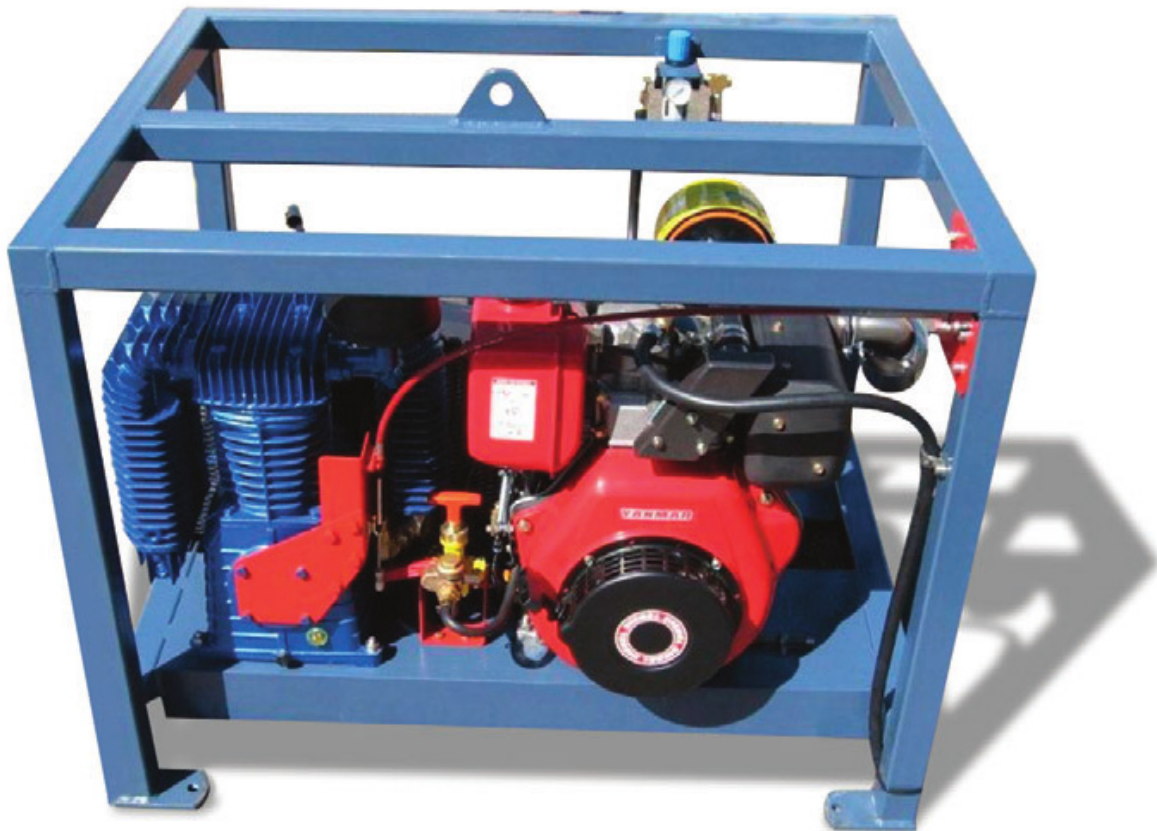

DIESEL AIR COMPRESSOR PUMPS & EQUIPMENT

Diesel Air Compressor

PART NO: PLI-DPAC-ES

Electric Start

SPARE PARTS1	
1	Piston Air Compressor
2	Pull Start
3	10HP Diesel Engine
4	Quick Air Connectors
5	Filter Regulator
6	Spark Arrestor

SPARE PARTS	
7	Pressure Relief
8	12 Volt Battery
9	Donaldson Air Filtration Unit
10	Air Receiver Pressure Gauge
11	Unloader Valve

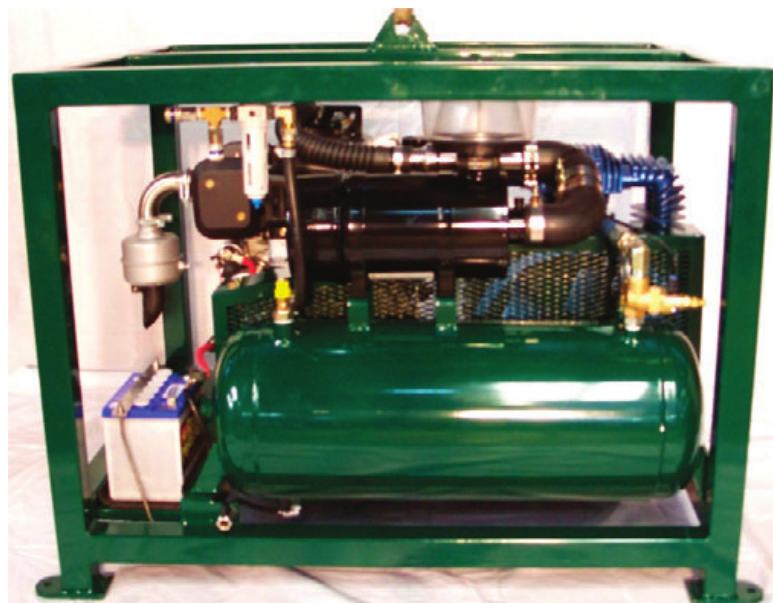
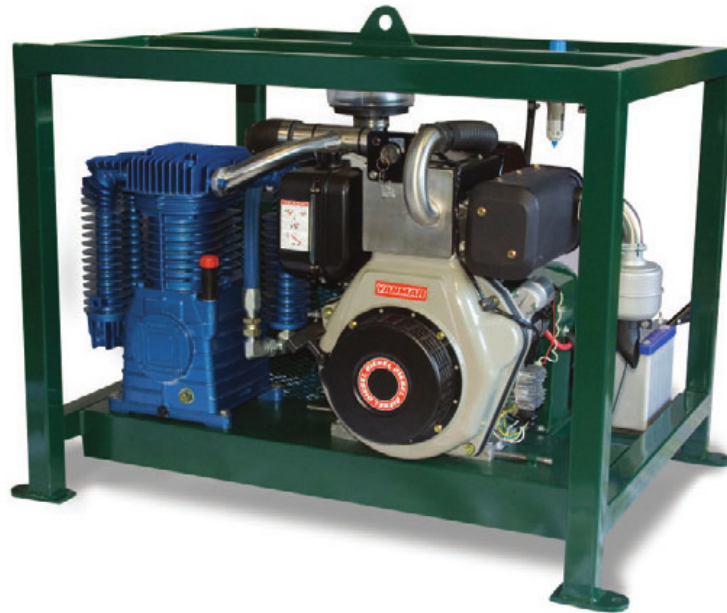

DIESEL AIR COMPRESSOR PUMPS & EQUIPMENT

Diesel Air Compressor

PART NO: PLI-DPAC-ES

For pull starting. Tune the fuel on. Tune the ignition key on. Hold the decompression lever down and slowly pull the pull start handle 1 time for fuel priming, then standard pull start procedures apply.

NOTE: **Do Not** use the decompression valve to stop the engine

Fill with Diesel only

For electric starting, Tune the fuel on. Tune the key to start the engine. Leave the key in the on position when the engine is running, so the battery can be charged. When the engine is stopped, tune the key off.

Tune fuel valve. ON & OFF

Pull start

Threaded rods to assist in engine alignment and belt tensioning



Pneumatic throttle control.

To check diesel oil

To stop the engine, pull this lever out until engine has completely stopped, then tune the ignition and fuel off.

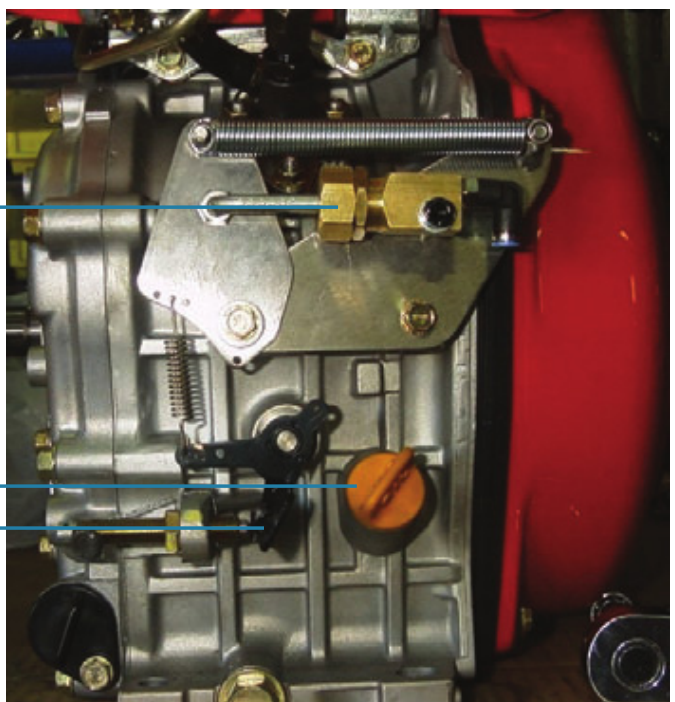

DIESEL AIR COMPRESSOR PUMPS & EQUIPMENT

Calibrated Chart Recorder

PART NO: PLI-CCR

10,000 PSI Calibrated Chart Recorder as part of an integrity testing rig. The whole unit is mounted in a hinged door stainless steel cabinet, fully weather sealed and lockable.

PART NUMBER
PLI-CCR

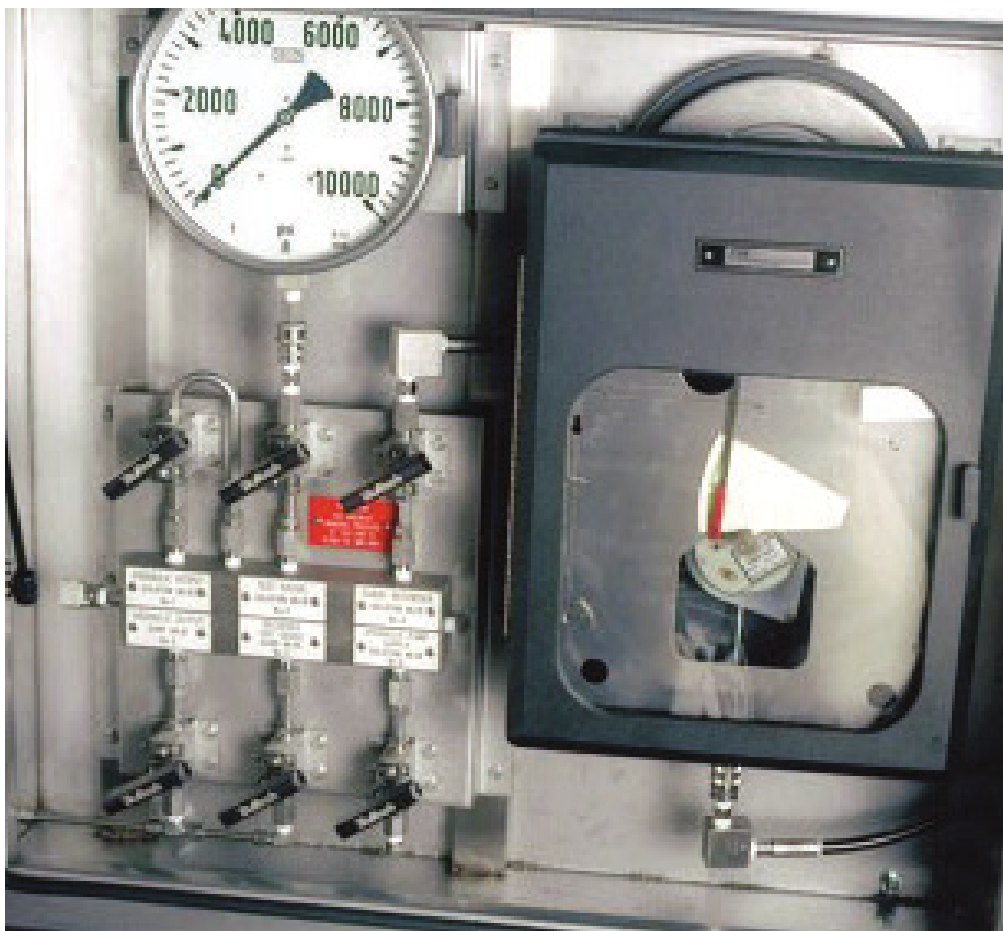

DIESEL AIR COMPRESSOR PUMPS & EQUIPMENT

Liquid Flush Pump

PART NO: PLI-LFP

4 litre tank, 10,000 PSI, liquid flush pump with oil lubricator, all hoses and fittings.

PART NUMBER
PLI-LFP

Compact unit used for liquid valve flushing.



DIESEL AIR COMPRESSOR PUMPS & EQUIPMENT

Whip Hose

PART NO: PLI-WP

The PLI Whip Hose is an integral part of the pump's delivery and safety feature. A short flexible high pressure hose allows the operator to step back from the valve and still have control of flow and isolation via the stainless steel ball valve. There is a universal Z-swivel with a 90 degree elbow and a LA114 lube adaptor, these items give greater flexibility when connecting to the valve.

The pressure gauge indicates the delivery pressure at the lubrication fitting. This safety whip has a high pressure full flow quick connector, for easy connection/disconnection to the supply hose.

PART NUMBER

PLI-WP

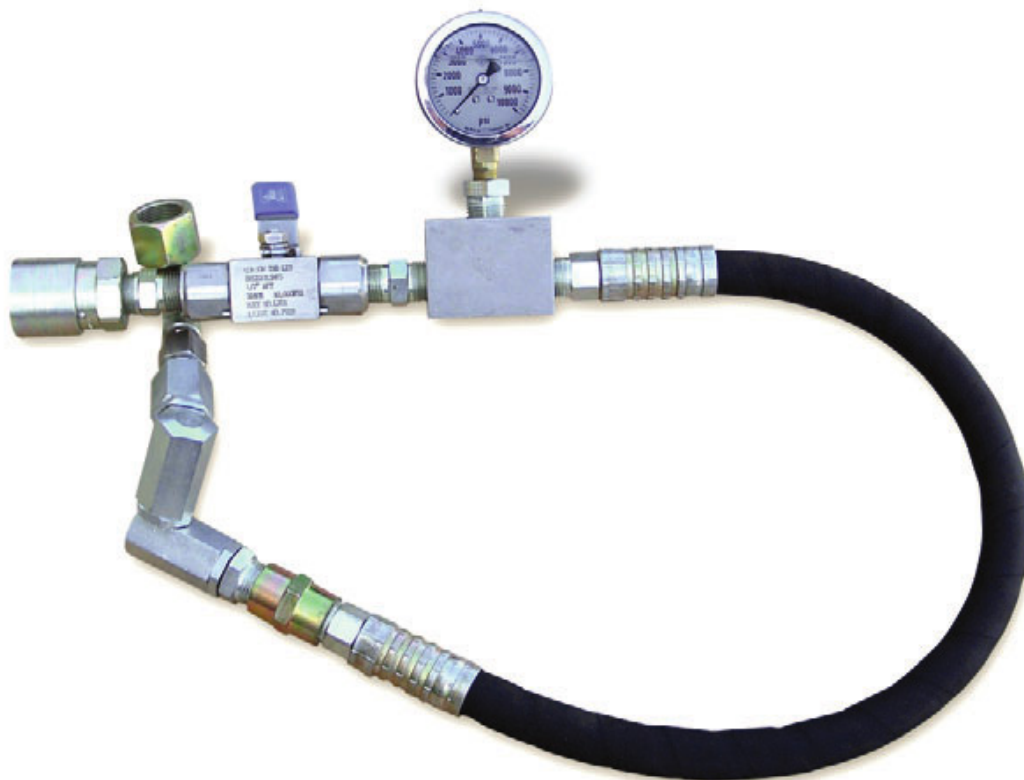



THANK YOU!

**GET IN
TOUCH
WITH US
NOW**

Bedriftsvegen 39, 4353 Klepp Stasjon Norway

Phone: +47 467 42 173

Email: mail@ors.as

WWW.ORS.AS